

17 via Cavalleggeri - 1/2000

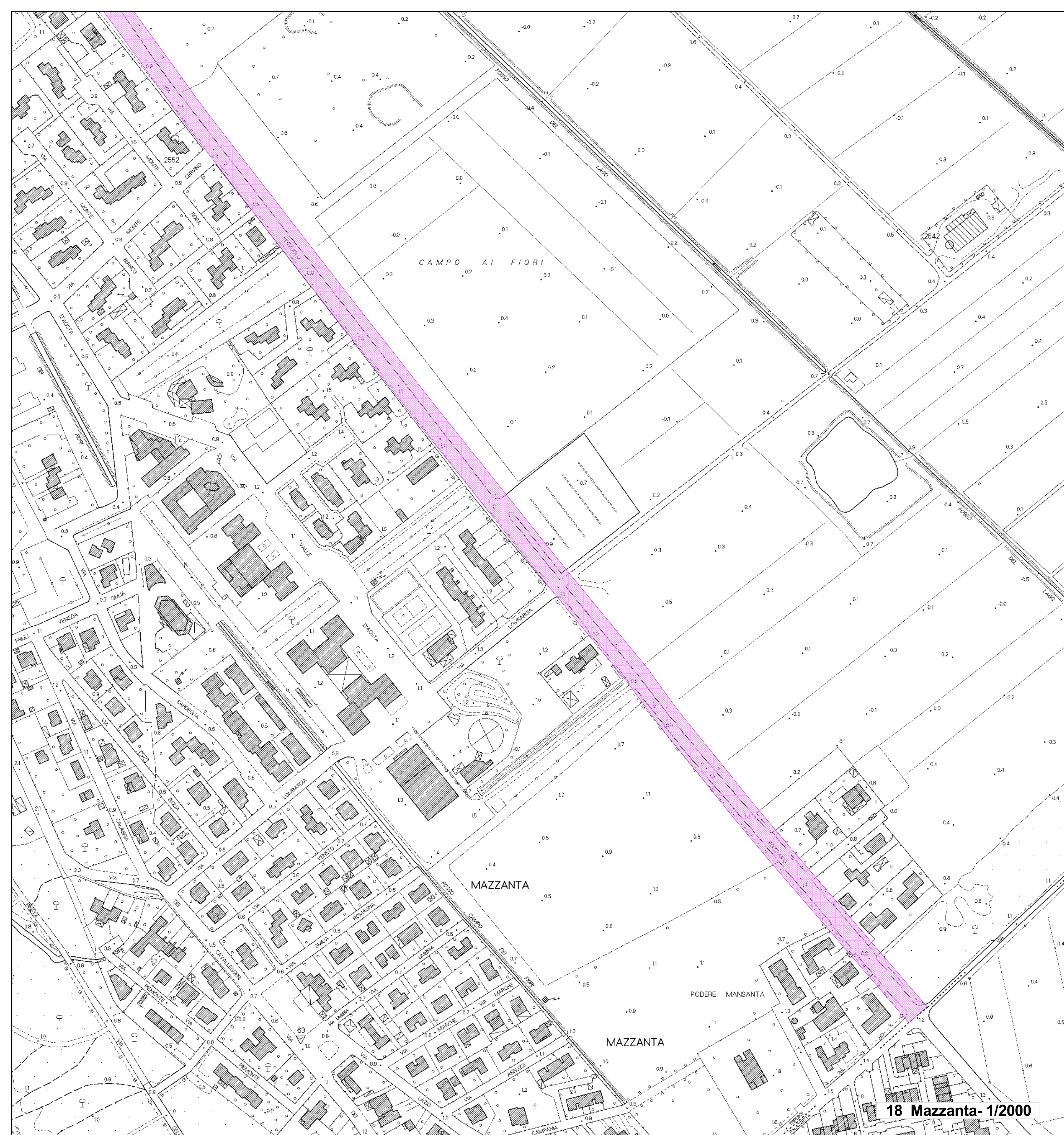

18 Mazzanta - 1/2000

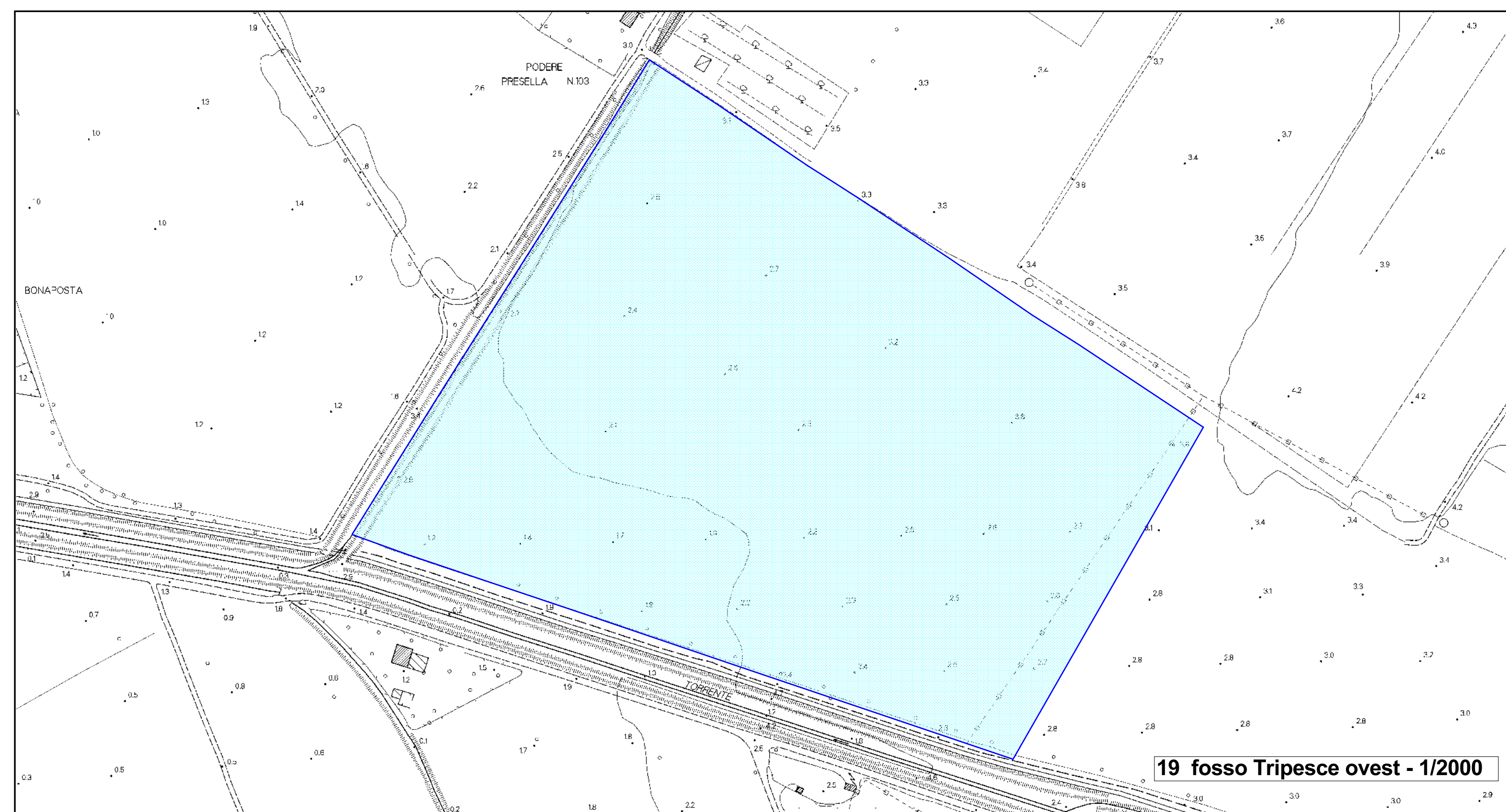

19 fossa Tripesce ovest - 1/2000

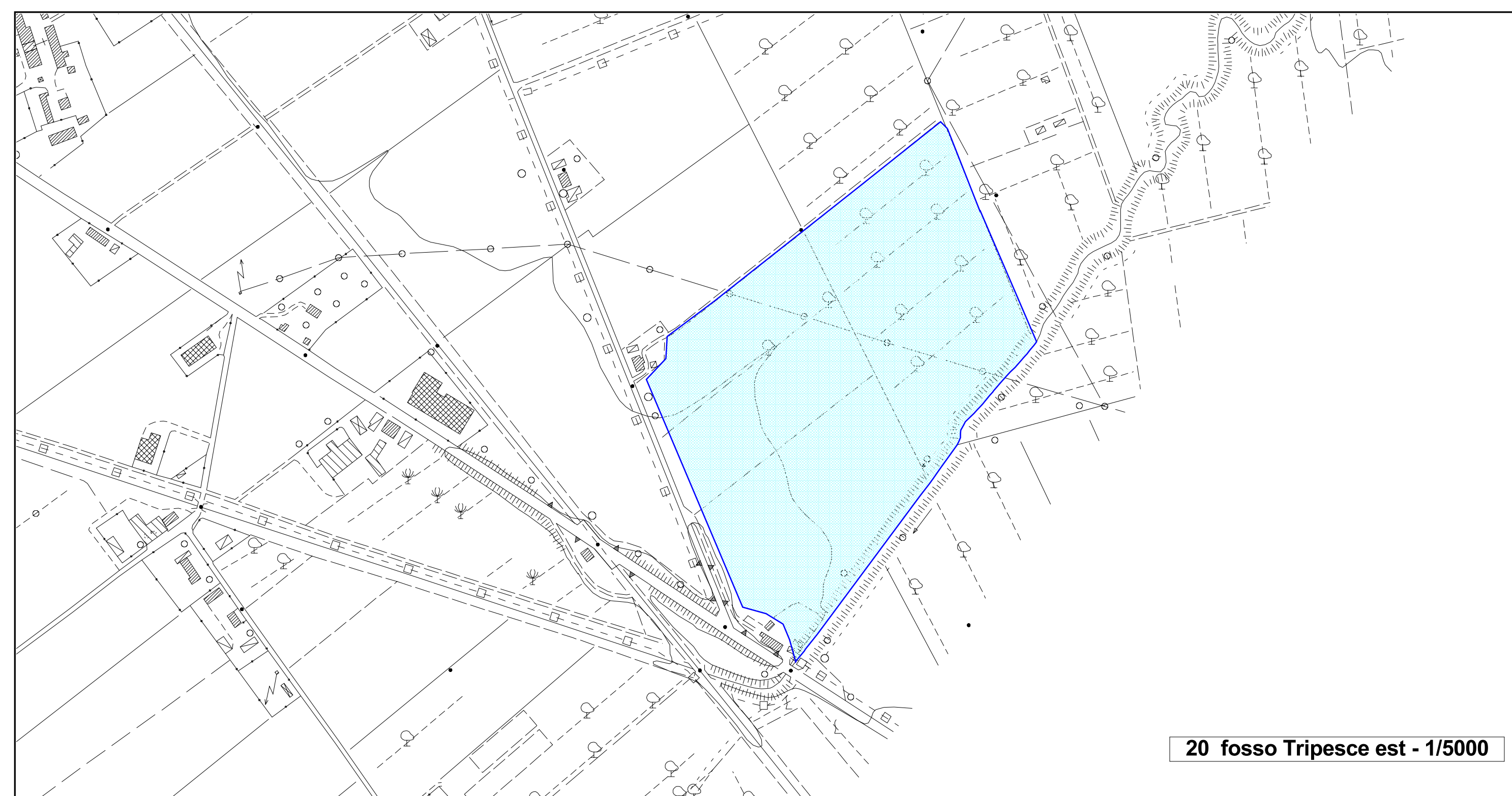

20 fossa Tripesce est - 1/5000

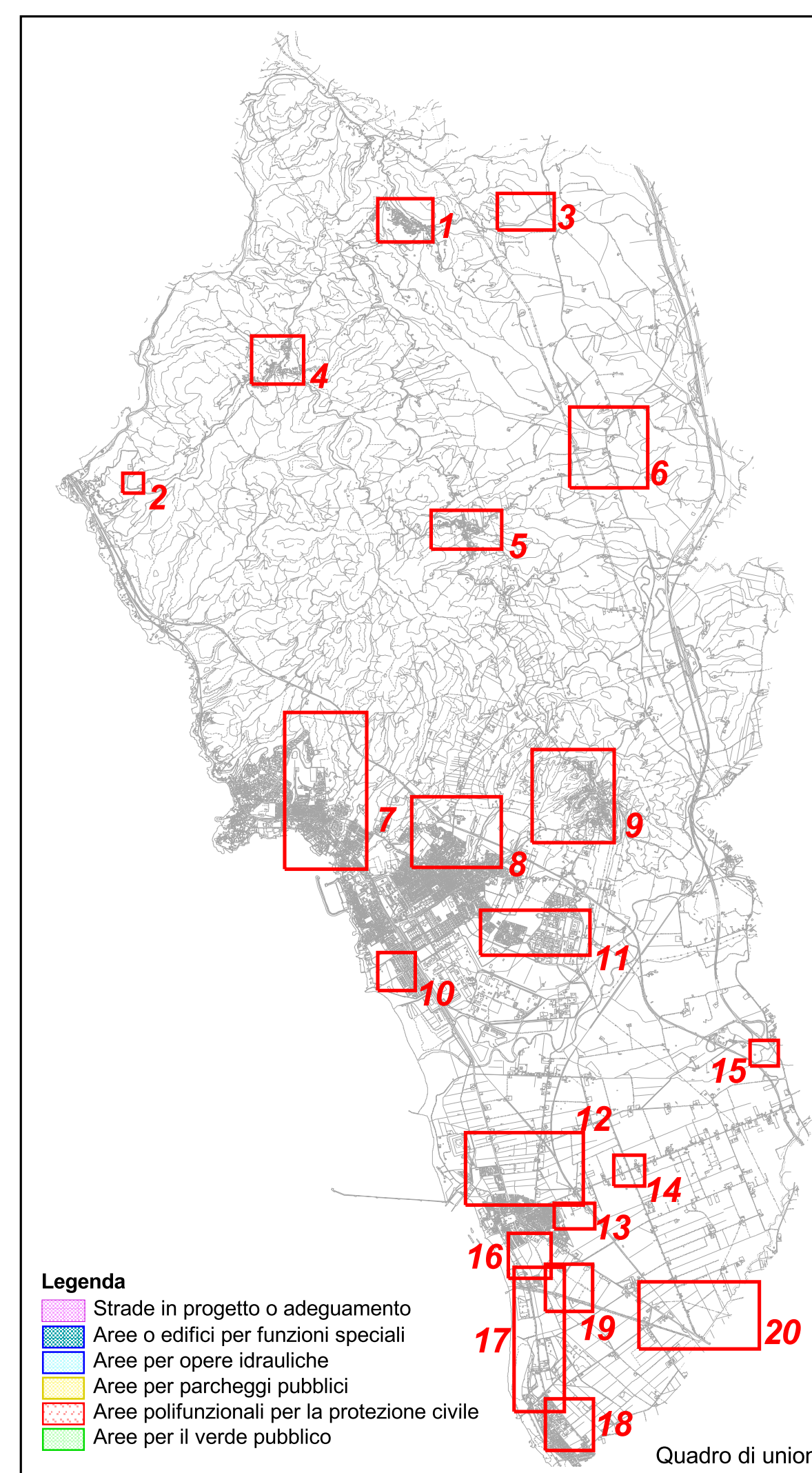

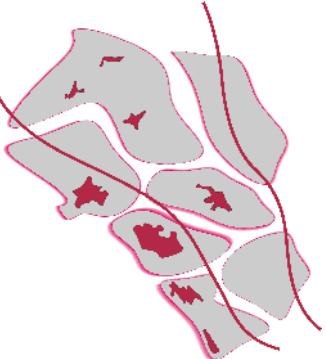

Comune di Rosignano M.mo
REGOLAMENTO URBANISTICO
Art. 55 L.R.T. n°12/005

PROGETTO
 tav. **Esp-3**

Responsabile del Procedimento:
 arch. Silvana Mancini

Ufficio SPT
 dott.ssa Lucia Anselmi
 dott.ssa Alessia Salsani
 arch. Davide Torelli

Agosto 2008

Art.55, c.4, lett.g LRT1/05: Beni
 soggetti a vincolo ai fini
 espropriativi ai sensi artt. 9 e 10
 D.P.R. 327/01

scale varie